

How to Draw an Attic Windows Block



using Quilt-Pro 6

The Attic Windows pattern is one of the most popular designs of the three dimensional quilt patterns. The pattern draws the eye to a "window" giving you a view to enjoy. These blocks are a great way to showcase large prints, fussy cuts or special blocks.

You'll see how to use different sized squares [window pane] and rectangles [panes] to create a unique design. We'll be creating a series of 6" Attic Window blocks by adjusting the panes and windows in each design to maintain the 6" size.

In this lesson, we will be adding the panes to the left side; but you can add them to the right side if you choose by drawing them on the right, or simply flipping the blocks after you add them to the quilt.

Let's start this lesson in a new Block window.

Select the Square tool and draw a 4" square.

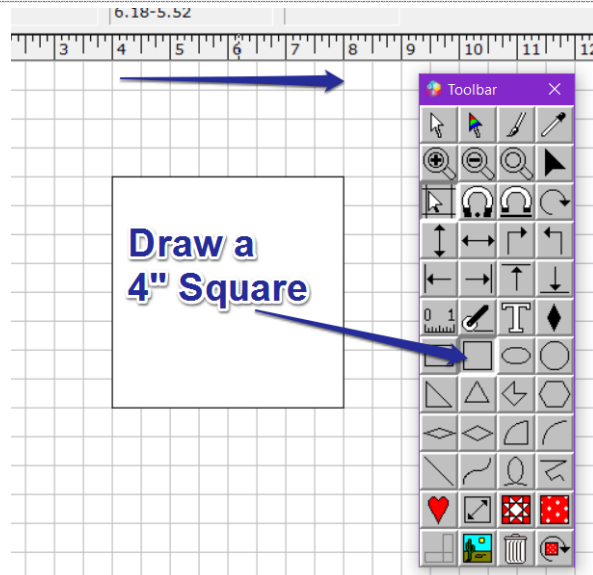

Select the Rectangle tool and draw two 2" x 4" rectangle.

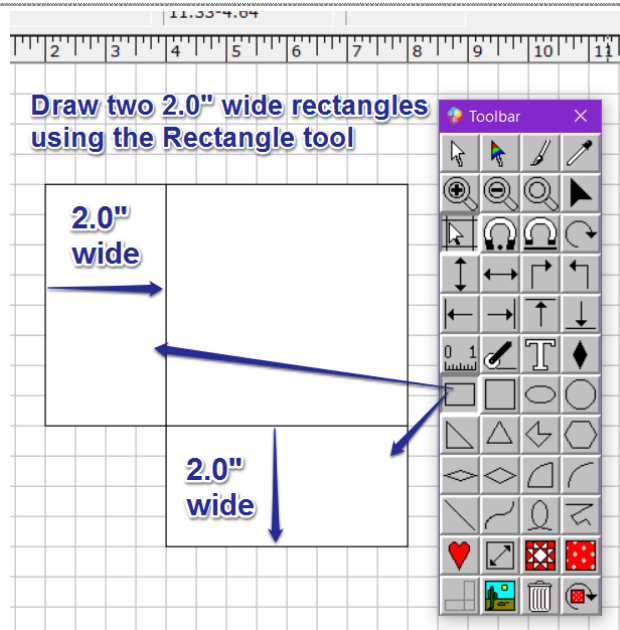

If you have any questions about this lesson, please contact Tech Support [here](#).

How to Draw an Attic Windows Block

using Quilt-Pro 6



Click the **Reshape** tool on the toolbar.

Be sure **Move Point** option is selected.

Click both of the two rectangles to reveal the black boxes used to adjust the patch dimensions.

Select one of points marked with X's in the image to the right, or the points on the bottom left of each patch. Press and hold the mouse as you drag the point to the corner to create a mitered corner.

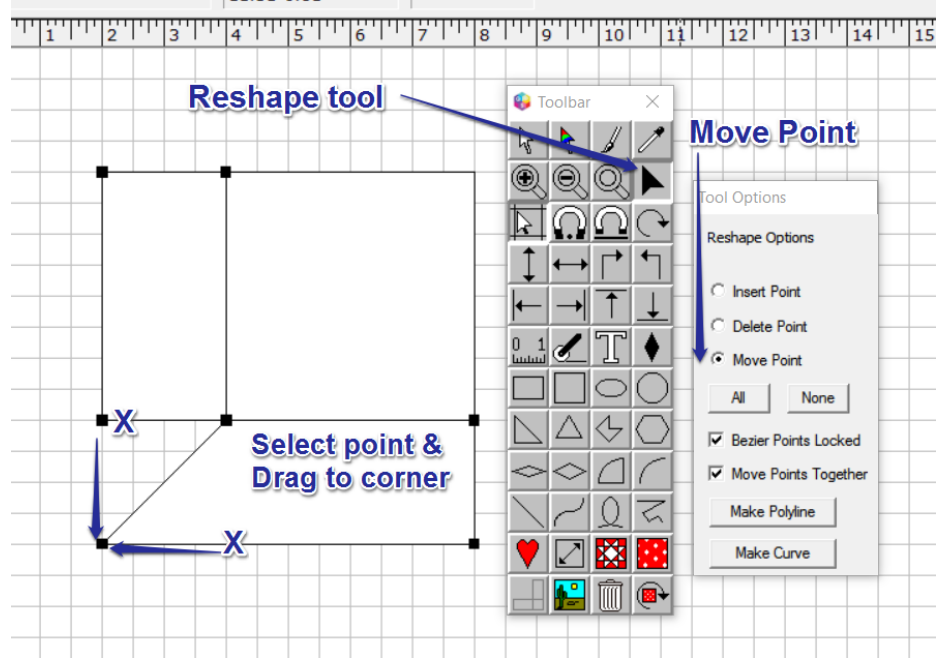

The finished 6" block



Here is a simple quilt made from this block.

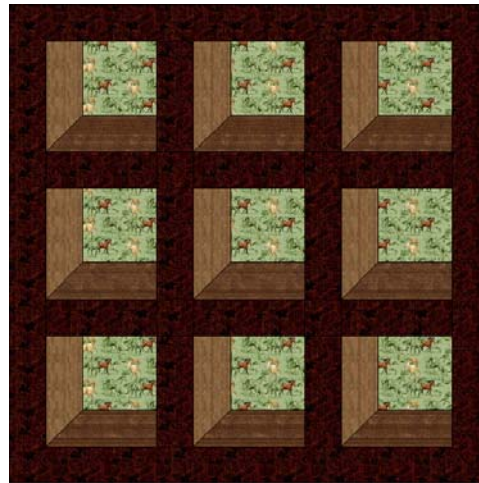

If you have any questions about this lesson, please contact Tech Support [here](#).

How to Draw an Attic Windows Block



using Quilt-Pro 6

This block has smaller Panes and a larger window to maintain the 6" size:



Here I mixed the first block and the second using an **Alternating** setting.

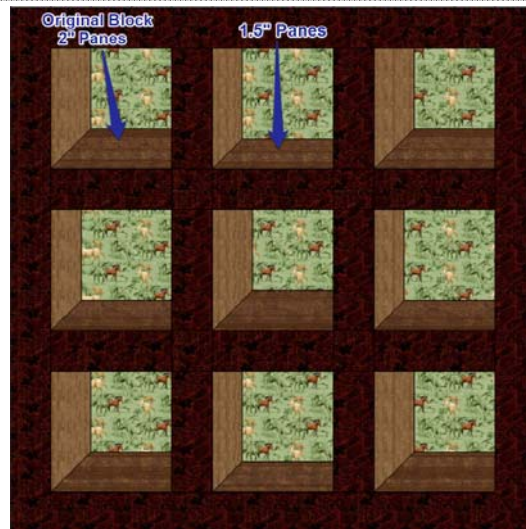

Here the two panes are different sizes. On the left, the pane is 1" wide; while the bottom pane is 1.5" wide.

Of course, the means you have to adjust the Window portion to 4.5"H. x 5"W to maintain the 6" block size.



Again, the two panes are different sizes. On the left, the pane is 1" wide; while the bottom pane is 1/2" wide.

Of course, the means you have to adjust the Window portion to 5.5"H. x 5"W to maintain the 6" block size.

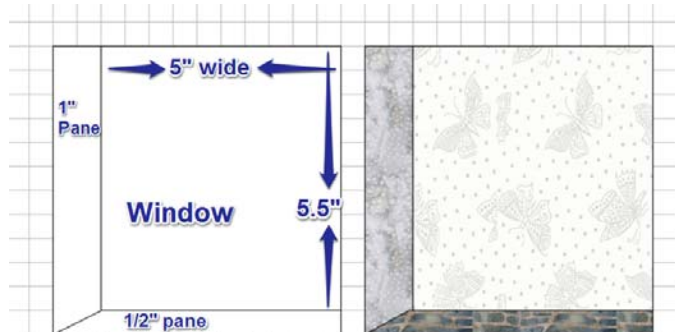

How to Draw an Attic Windows Block

using Quilt-Pro 6



This is how the quilt would look if you used all four blocks in a quilt.

For a traditional Attic Windows quilt, you would choose only one window pane size for all your blocks, but you don't have to. Feel free to mix and match the different sizes in one quilt.



There are many more options for Window and Pane sizes and positions. Experiment with new sizes to get the look you're going for.

If you have any questions about this lesson, please contact Tech Support [here](#).